

# SOLENOID VALVE INSPECTION

B3E051721280W01

## Resistance Inspection (On-Vehicle Inspection)

### Caution

- Water or foreign material entering the connector can cause a poor connection or corrosion. Be sure not to drop water or foreign material on the connector when disconnecting it.

1. Remove the battery cover. (See [BATTERY REMOVAL/INSTALLATION \[ZJ, Z6\]](#).) (See [BATTERY REMOVAL/INSTALLATION \[LF\]](#).)
2. Disconnect the negative battery cable.
3. Remove the under cover.
4. Disconnect the transaxle connector.

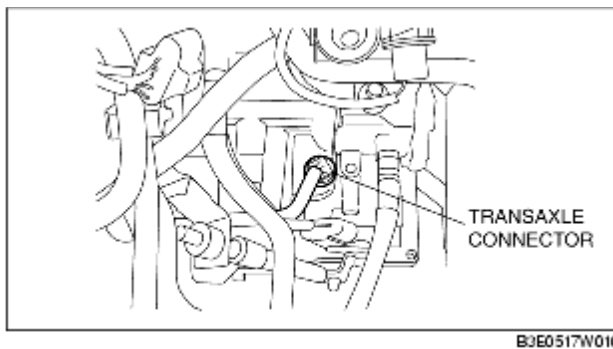

### Note

- When inspecting the pressure control solenoid, connect the ground connection to the ground terminal (terminal I) of the pressure control solenoid inside the solenoid valve connector.

5. Measure the resistance between the following terminals.

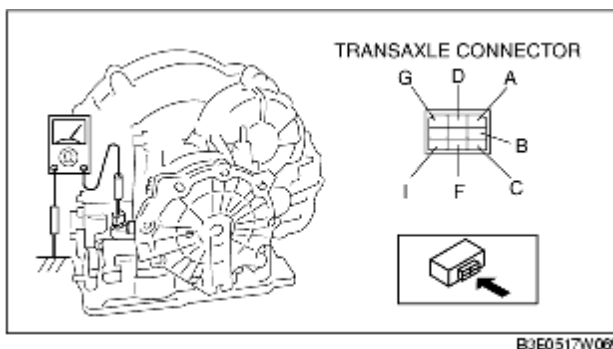

- If there is any malfunction, inspect the ground, then perform the operating inspection.

**ATF temperature: -40-150 °C {-40-302 °F}**

Terminal	Solenoid valve	Resistance (ohm)
----------	----------------	------------------

A-GND	Shift solenoid A	1.0-4.2
C-GND	Shift solenoid B	1.0-4.2
G-GND	Shift solenoid C	1.0-4.2
B-GND	Shift solenoid D	10.9-26.2
F-GND	Shift solenoid E	10.9-26.2
D-I	Pressure control	2.4-7.3

6. Connect the transaxle connector.

7. Install the under cover.

8. Connect the negative battery cable.

9. Install the battery cover. (See [BATTERY REMOVAL/INSTALLATION \[ZJ, Z6\]](#).) (See [BATTERY REMOVAL/INSTALLATION \[ZJ, Z6\]](#).)

## Operating Inspection

1. Disconnect the transaxle connector.

### Caution

- Do not apply battery position voltage to terminals A, B, C, D, F and G for more than 3 s.

### Note

- Because the operation sound of the valves is small, perform inspection in a quiet place.

2. Apply battery positive voltage to the transaxle connector terminals A, B, C, F or G and battery negative voltage to GND, and verify that operating sound is heard from the solenoid.

- If the "click" is not heard, inspect the transaxle harness.
  - If the transaxle harness is normal, perform the resistance inspection (off-vehicle inspection).
  - If there is any malfunction, repair or replace the transaxle harness.

3. Apply battery positive voltage to the transaxle connector terminal D and battery negative voltage to the transaxle connector terminal I, and verify that operating sound is heard from solenoid.

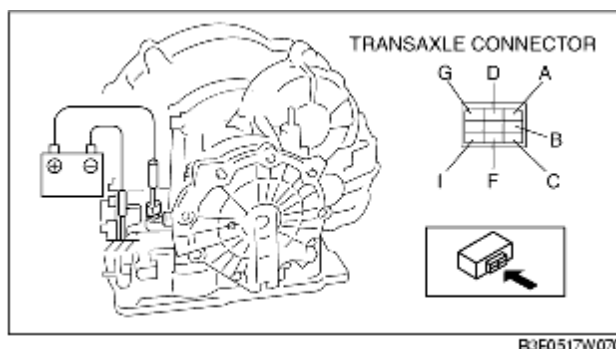

- If the "click" is not heard, inspect the transaxle harness.
  - If transaxle harness is normal, perform the resistance inspection (off-vehicle inspection).
  - If there is any malfunction, repair or replace the transaxle harness.

## Resistance Inspection (Off-Vehicle Inspection)

1. Remove the control valve body. (See [SOLENOID VALVE REMOVAL/INSTALLATION.](#))
2. Measure the resistance of each solenoid valve individually.
  - If there is any malfunction, replace the solenoid valve.
3. Install the control valve body. (See [SOLENOID VALVE REMOVAL/INSTALLATION.](#))

### Pressure control solenoid

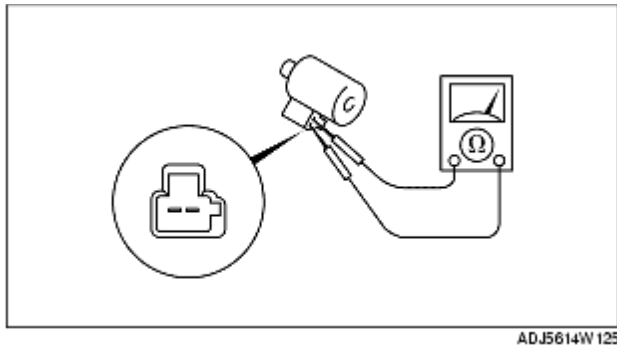

**Resistance**  
2.4-7.3 ohms  
(ATF temperature: -40-150 °C  
{-40-302 °F})

### Shift solenoid A, B, C

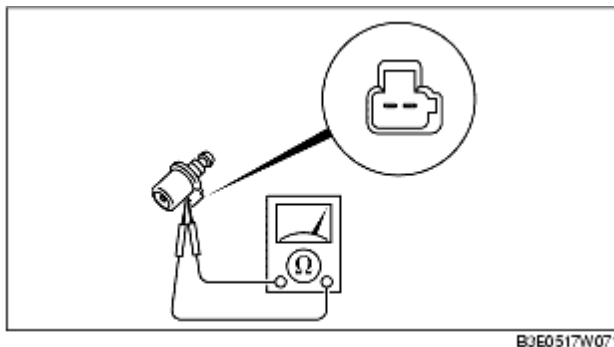

**Resistance**  
1.0-4.2 ohms  
(ATF temperature: -40-150 °C  
{-40-302 °F})

### Shift solenoid D, E

**Resistance**  
**10.9-26.2 ohms**  
**(ATF temperature: -40-150 °C**  
**{-40-302 °F})**